

FITTINGS

PVC FITTINGS FOR C900 PIPE



**PVC for
C900**

Engineered for Durability

Size 4"-12"

HARCO CLASS 150 PVC FITTINGS

HARCO PVC fittings are injection molded from virgin PVC compound for the same high strength and corrosion resistance you are now receiving from the C-900 pipe. These HARCO PVC fittings make possible an all PVC system. Fittings meet DR18 requirements of AWWA C-900.

**High
Strength**

SUGGESTED SPECIFICATION

All fittings for C-900 pipe shall be manufactured in one piece of injection molded PVC compound meeting ASTM D1784. Fittings shall be designed to withstand a minimum of 755 psi quick burst pressure @ 73°F tested in accordance with ASTM D1599. Bells shall be gasketed joint conforming to ASTM D3139 with gaskets conforming to ASTM F477. Ductile Iron or Cast Iron Push-on Joint or M.J. will be allowed as alternative when PVC sizes are not available.

**All PVC
System**

STANDARD JOINT DIMENSIONS - IN INCHES

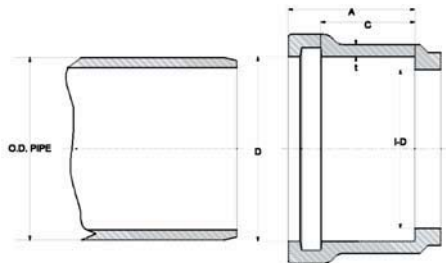

**Easy
Installation**

Nominal Diameter	A	C	D	I-D	t	O.D.
4	4.3	3.1	4.86	4.45	.32	4.80
6	4.8	3.5	6.96	6.38	.45	6.90
8	5.4	4.0	9.13	8.38	.58	9.05

**High Flow
Capacity**



HARRINGTON CORPORATION • P.O. BOX 10335 • LYNCHBURG, VIRGINIA 24506

PHONE: 434-845-7094 • FAX: 434-845-8562 • E-MAIL: sales@harcofittings.com • WEB: www.harcofittings.com

PF135-021007

PVC Fittings for C900 Pipe *Product Sheet*

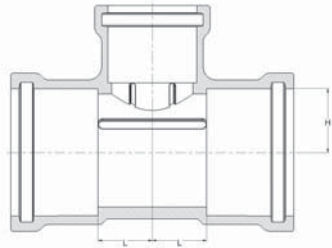

Tee

Cat. No.	Size	L	H	Wt
312-0404	4 x 4	2.8	2.8	6.7
312-0604	6 x 4	2.8	3.9	11.5
312-0606	6 x 6	3.9	3.9	14.5
312-0804	8 x 4	2.8	5.1	19.0
312-0806	8 x 6	3.9	5.1	23.0
312-0808	8 x 8	5.1	5.1	26.0

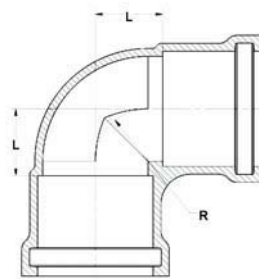

90 Bend

Cat. No.	Size	L	R	Wt
318-040	4	2.8	2.2	6.0
318-060	6	3.9	3.2	12.0
318-080	8	5.1	4.2	23.0

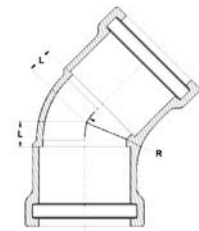

45 Bend

Cat. No.	Size	L	R	Wt
322-040	4	1.3	2.2	4.1
322-060	6	1.8	3.2	8.2
322-080	8	2.2	4.2	16.1

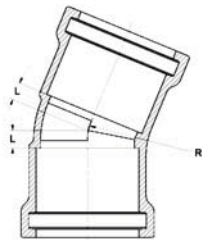

22 1/2 Bend

Cat. No.	Size	L	R	Wt
324-040	4	0.9	2.2	4.0
324-060	6	1.2	3.2	8.0
324-080	8	1.3	4.2	15.0

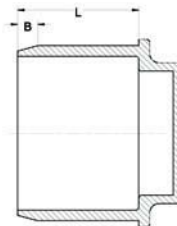

Plug

Cat. No.	Size	L	B	Wt
344-060	6	4.75	0.8	3.1
344-080	8	5.25	1.0	6.2

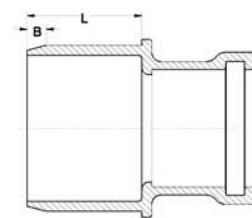

Reducer

Cat. No.	Size	L	B	Wt
317-0604	6 x 4	4.75	0.8	10.4
317-0806	8 x 6	5.25	1.0	19.6

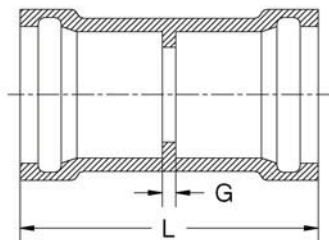

Line Coupling

Cat. No.	Size	L	G	Wt
308-040	4	8.9	0.4	2.9
308-060	6	10.0	0.5	6.0
308-080	8	11.3	0.6	11.5

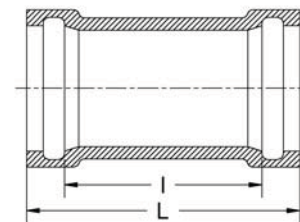

Repair Coupling

Cat. No.	Size	L	I	Wt
309-040	4	8.9	6.6	3.4
309-060	6	10.0	7.5	6.7
309-080	8	11.3	8.6	12.5

Please see price list and engineering data sheets for more sizes & configurations.



HARRINGTON CORPORATION • P.O. BOX 10335 • LYNCHBURG, VIRGINIA 24506

PHONE: 434-845-7094 • FAX: 434-845-8562 • E-MAIL: sales@harcofittings.com • WEB: www.harcofittings.com

PF135-021007