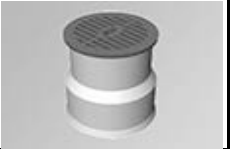

HARCO PRICE LIST

FABRICATED DRAINAGE PRODUCTS

CUSTOM DRAIN BASIN			
With Round Grate		1, 2, 3, 4, 5	
			
BASIN DIAMETER	OUTLET SIZE	PART NUMBER	LIST PRICE
(Overall Height 5' or Less)			
8"	4" - 8"	92-1008	\$385.00
10"	4" - 10"	92-1010	\$528.00
12"	4" - 12"	92-1012 *	\$774.00
15"	4" - 15"	92-1015 *	\$1,108.00
18"	4" - 18"	92-1018	\$1,298.00
24"	4" - 24"	92-1024	\$1,628.00
30"	4" - 30"	92-1030	\$2,624.00
36"	4" - 30"	92-1036	Call
(Overall Height >5' to 10')			
8"	4" - 8"	92-1108	\$468.00
10"	4" - 10"	92-1110	\$651.00
12"	4" - 12"	92-1112 *	\$996.00
15"	4" - 15"	92-1115 *	\$1,264.00
18"	4" - 18"	92-1118	\$1,460.00
24"	4" - 24"	92-1124	\$1,823.00
30"	4" - 30"	92-1130	\$3,200.00
36"	4" - 30"	92-1136	Call

* Optional Round or Square-Hinged Grate

INLINE DRAIN			
With Round Grate		1, 2, 4, 5	
			
INLINE DIAMETER	OUTLET SIZE	PART NUMBER	LIST PRICE
6"	4" - 6"	93-aa06xx	\$103.00
8"	4" - 8"	93-aa08xx	\$118.00
10"	4" - 10"	93-aa10xx	\$149.00
12"	4" - 12"	93-aa12xx *	\$471.00
15"	4" - 15"	93-aa15xx *	\$556.00
18"	4" - 18"	93-aa18xx	\$675.00
24"	4" - 24"	93-aa24xx	\$1,256.00
30"	4" - 30"	93-aa30xx	\$1,517.00
36"	4" - 36"	93-aa36xx	Call

* Optional Round or Square-Hinged Grate

" xx " = Outlet Diameter Size (e.g. 04, 06, 08, 10, 12, etc.)

" aa " = Outlet Type Code:

- 10 - Corrugated HDPE / PP Hub
- 20 - F949
- 24 - SDR35 Swr Hub
- 25 - SDR35 Swr Gsk
- 26 - SDR26 Swr Hub
- 27 - SDR26 Swr Gsk
- 34 - C900 Hub
- 36 - C900 Gsk
- 40 - IPS Hub
- 42 - IPS Gsk

Ex. 12" Inline Drain for HDPE hub with 8" outlet - Part #93-101208

NOTES:

1. Prices include H10 pedestrian, H25 standard, H25 solid round cover / grate with frame for 12" diameter or larger structures, or one-piece light duty grate or cover for 8" and 10" diameter structures. (H10 pedestrian grates available 12" through 30" only).
2. Additional charges for substituting Domed Grate and/or adding locking options, see adders Page 3. Call for Bronze Grate price adder.
3. Basins taller than 84" are provided in 2 pieces and require field assembly.
4. Prices include F477 pipe gaskets when connecting to corrugated HDPE / PP pipe 4" thru 30" diameters.
5. Pipe lube is required for all gasketed pipe connections to HARCO drain basins and inline drains. Pipe lube is not supplied by HARCO. Customer should acquire required pipe lube from local supply house or the pipe manufacturer.

Terms and Conditions:

Freight Policy

For HARCO Products shown on this price sheet: Freight prepaid on orders \$2500 net price and over, F.O.B. HARCO facility, delivered within the continental U.S.

Return Policy

1. Due to the fact that HARCO drainage structures are custom made, they are Non-cancelable and Non-returnable.
2. All return requests of grates must be pre-approved by HARCO management.
3. A 25% restocking fee applies to approved returns.
4. All return freight to be paid by customer.

HARCO PRICE LIST

FABRICATED DRAINAGE PRODUCTS

CUSTOM DRAIN BASIN			
With 2x2 Square Traffic Grate 1, 2, 4, 5			
BASIN SIZE	OUTLET SIZE	PART NUMBER	LIST PRICE
(Overall Height 5' or Less)			
12"	4" - 12"	92-1212	\$841.00
15"	4" - 15"	92-1215	\$1,173.00
18"	4" - 18"	92-1218	\$1,370.00
24"	4" - 24"	92-1224	\$1,698.00
30"	4" - 30"	92-1230	\$2,691.00
(Overall Height >5' to 10')			
12"	4" - 12"	92-1312	\$1,064.00
15"	4" - 15"	92-1315	\$1,318.00
18"	4" - 18"	92-1318	\$1,532.00
24"	4" - 24"	92-1324	\$1,891.00
30"	4" - 30"	92-1330	\$3,269.00



CUSTOM DRAIN BASIN			
With 2x2 Square Curb Inlet Grate 1, 2, 3, 4, 5			
BASIN SIZE	OUTLET SIZE	PART NUMBER	LIST PRICE
(Overall Height 5' or Less)			
12"	4" - 12"	92-1612	\$1,723.00
15"	4" - 15"	92-1615	\$1,863.00
18"	4" - 18"	92-1618	\$2,098.00
24"	4" - 24"	92-1624	\$2,392.00
30"	4" - 30"	92-1630	\$3,233.00
(Overall Height >5' to 10')			
12"	4" - 12"	92-1712	\$1,834.00
15"	4" - 15"	92-1715	\$2,098.00
18"	4" - 18"	92-1718	\$2,361.00
24"	4" - 24"	92-1724	\$2,710.00
30"	4" - 30"	92-1730	\$3,498.00



CUSTOM DRAIN BASIN			
With 2x3 Rectangular Traffic Grate 1, 2, 4, 5			
BASIN SIZE	OUTLET SIZE	PART NUMBER	LIST PRICE
(Overall Height 5' or Less)			
18"	4" - 18"	92-1418	\$1,439.00
24"	4" - 24"	92-1424	\$1,767.00
30"	4" - 30"	92-1430	\$2,758.00
36"	4" - 30"	92-1436	Call
(Overall Height >5' to 10')			
18"	4" - 18"	92-1518	\$1,600.00
24"	4" - 24"	92-1524	\$1,960.00
30"	4" - 30"	92-1530	\$3,341.00
36"	4" - 30"	92-1536	Call



CUSTOM DRAIN BASIN			
With 2x3 Rectangular Curb Inlet Grate 1, 2, 3, 4, 5			
BASIN SIZE	OUTLET SIZE	PART NUMBER	LIST PRICE
(Overall Height 5' or Less)			
18"	4" - 18"	92-1818	\$2,273.00
24"	4" - 24"	92-1824	\$2,621.00
30"	4" - 30"	92-1830	\$3,437.00
36"	4" - 30"	92-1836	Call
(Overall Height >5' to 10')			
18"	4" - 18"	92-1918	\$2,582.00
24"	4" - 24"	92-1924	\$2,975.00
30"	4" - 30"	92-1930	\$3,644.00
36"	4" - 30"	92-1936	Call



- NOTES:**
1. Locking Grate Charges / Options, see Page 3.
 2. Basins taller than 84" are provided in 2 pieces and require field assembly.
 3. Choice of Standard, Diagonal or High Flow Grate where available.
 4. Prices include F477 pipe gaskets when connecting to corrugated HDPE / PP pipe 4" thru 30" diameters.
 5. Pipe lube is required for all gasketed pipe connections to HARCO drain basins and inline drains. Pipe lube is not supplied by HARCO. Customer should acquire required pipe lube from local supply house or the pipe manufacturer.

HARCO PRICE LIST

FABRICATED DRAINAGE PRODUCTS

CUSTOM DRAIN BASIN

With Weir

(24", 30" & 36" Diameter Structures)



Call for Pricing

CUSTOM DRAIN BASIN

With Snout

(18", 24", 30" & 36" Diameter Structures)



Call for Pricing

DROP-IN ROUND GRATE



SIZE	PART NUMBER	LIST PRICE
6"	94-3806	\$52.80
8"	94-3808	\$59.40
10"	94-3810	\$78.10
12"	94-3812	\$103.40
15"	94-3815	\$159.50
18"	94-3818	\$214.00
24"	94-3824	\$386.00
30"	94-3830	\$652.00

These Ductile Iron grates are for light duty turf and landscape applications only. These grates are designed to fit on corrugated plastic drainage pipes.

RISER SECTIONS

Used to add height to existing structure

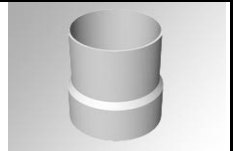

SIZE	PART NUMBER	LIST PRICE
8"	92-3008x	\$28.00
10"	92-3010x	\$29.00
12"	92-3012x	\$51.00
15"	92-3015x	\$54.00
18"	92-3018x	\$65.00
24"	92-3024x	\$82.00
30"	92-3030x	\$166.00
36"	92-3036x	Call

" x " = Height in Feet; Ex. 12" Riser x two feet tall: Part #92-30122

DOMED GRATE OPTION PRICE ADDER

(Domed grates designed to fit and are available with HARCO drain basins and inline drains)



SIZE	PART NUMBER	LIST PRICE
6"	94-7206	\$27.50
8"	94-7208	\$33.00
10"	94-7210	\$38.50
12"	94-7212	\$56.10
15"	94-7215	\$111.10
18"	94-7218	\$203.50
24"	94-7224	\$248.60
30"	94-7230	\$491.70

When substituting Domed Grate for standard grate, add the Domed Grate list price surcharge to the Drain Basin or Inline Drain list price prior to discount

LOCKING GRATE OPTION PRICE ADDER

GRATE OPTION	PART NUMBER	LIST PRICE
Round, Traffic and Square-Hinged Grate/Frame	94-50	\$90.00
Curb Inlet Grate/Frame	94-52	\$250.00

When including the Locking Grate option, add the Locking Grate list price surcharge to the Drain Basin or Inline Drain list price prior to discount

HARCO PRICE LIST

FABRICATED DRAINAGE PRODUCTS

Minimum Angle Chart

Use for 8" - 36" Standard Drain Basins, 8" - 30" Curb Inlet Structures and Traffic Structures

Does not apply to basins with a Snout, Weir, or Branch Adders

Adaptor Size	Basin Size							
	8"	10"	12"	15"	18"	24"	30"	36"
4" - 4"	70	55	50	42	35	25	24	21
4" - 6"	75	70	55	47	40	29	25	23
4" - 8"	100	80	65	55	45	35	28	26
4" - 10"		95	75	62	52	40	32	28
4" - 12"			85	70	55	45	40	30
4" - 15"				80	65	51	44	33
4" - 18"					76	60	50	36
4" - 24"						75	62	41
4" - 30"							75	45
6" - 6"	90	75	65	55	44	33	30	26
6" - 8"	115	85	75	63	51	39	34	29
6" - 10"		105	85	70	55	43	38	32
6" - 12"			95	75	63	48	45	34
6" - 15"				86	72	56	48	37
6" - 18"					84	63	55	40
6" - 24"						77	66	46
6" - 30"							75	51
8" - 8"	165	90	80	70	55	44	35	32
8" - 10"		115	88	76	63	48	45	35
8" - 12"			102	83	70	52	48	38
8" - 15"				95	78	60	55	41
8" - 18"					90	70	60	45
8" - 24"						82	70	51
8" - 30"							80	57
10" - 10"		160	90	82	70	53	48	38
10" - 12"			115	85	75	58	50	41
10" - 15"				103	85	65	58	45
10" - 18"					97	72	65	49
10" - 24"						88	75	56
10" - 30"							85	62
12" - 12"			150	90	82	64	56	44
12" - 15"				112	87	69	60	48
12" - 18"					102	78	68	53
12" - 24"						92	80	60
12" - 30"							90	67
15" - 15"				150	90	77	69	53
15" - 18"					110	84	75	58
15" - 24"						98	85	66
15" - 30"							96	73
18" - 18"					150	90	78	63
18" - 24"						108	88	72
18" - 30"							100	82
24" - 24"						150	90	81
24" - 30"							115	91
30" - 30"							150	101

HARRINGTON CORPORATION • P.O. BOX 10335 • LYNCHBURG, VIRGINIA 24506-0335

PHONE: 434-845-7094 • FAX: 434-845-8562 • E-MAIL: sales@harcofittings.com • WEB: www.harcofittings.com