

























**CALL FOR OTHER CONFIGURATIONS**

**Material:** Dual Rated 4710/3608 HDPE Resin, Black  
**Standards:** AWWA C906

**IPS 22½° Bend**

Two-Segment, Fabricated

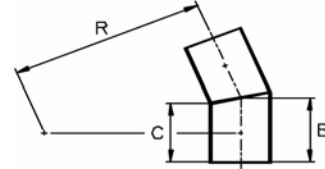

Nominal Size	Body DR	End DR	Part Number	Dimensions R x C x B (in)	Weight per Item (lbs.)	List Price
6	17	17	65-382606	15¼ x 6 x 6¾	6.0	\$ 92.00
	11	17	65-342606		6.0	\$ 126.00
	11	15.5	65-332606		6.0	\$ 126.00
	11	13.5	65-322606		6.0	\$ 126.00
	11	11	65-312606		6.0	\$ 92.00
	9	11	65-292606		7.0	\$ 129.00
	9	9	65-282606		7.0	\$ 95.00
	7	9	65-262606		7.0	\$ 135.00
	7	7	65-252606		7.0	\$ 100.00
8	17	17	65-382608	16¼ x 6½ x 7¾	10.0	\$ 98.00
	11	17	65-342608		10.0	\$ 144.00
	11	15.5	65-332608		10.0	\$ 144.00
	11	13.5	65-322608		10.0	\$ 144.00
	11	11	65-312608		10.0	\$ 106.00
	9	11	65-292608		12.0	\$ 150.00
	9	9	65-282608		12.0	\$ 112.00
	7	9	65-262608		15.0	\$ 164.00
	7	7	65-252608		15.0	\$ 126.00
10	17	17	65-382610	17¼ x 6½ x 7¾	11.0	\$ 119.00
	11	17	65-342610		17.0	\$ 179.00
	11	15.5	65-332610		17.0	\$ 179.00
	11	13.5	65-322610		17.0	\$ 179.00
	11	11	65-312610		17.0	\$ 135.00
	9	11	65-292610		20.0	\$ 196.00
	9	9	65-282610		20.0	\$ 151.00
	7	9	65-262610		24.0	\$ 216.00
	7	7	65-252610		24.0	\$ 172.00
12	17	17	65-382612	19½ x 8 x 9¼	19.0	\$ 160.00
	11	17	65-342612		28.0	\$ 230.00
	11	15.5	65-332612		28.0	\$ 230.00
	11	13.5	65-322612		28.0	\$ 230.00
	11	11	65-312612		28.0	\$ 175.00
	9	11	65-292612		34.0	\$ 256.00
	9	9	65-282612		34.0	\$ 204.00
	7	9	65-262612		42.0	\$ 283.00
	7	7	65-252612		42.0	\$ 232.00
14	17	17	65-382614	21 x 8 x 9¾	23.0	\$ 186.00
	11	17	65-342614		35.0	\$ 296.00
	11	15.5	65-332614		35.0	\$ 296.00
	11	13.5	65-322614		35.0	\$ 296.00
	11	11	65-312614		35.0	\$ 203.00
	9	11	65-292614		41.0	\$ 347.00
	9	9	65-282614		41.0	\$ 254.00
	7	9	65-262614		51.0	\$ 378.00
	7	7	65-252614		51.0	\$ 285.00

IPS Fabricated, Butt Fusion

**DISCOUNT CATEGORY A**

**CALL FOR OTHER CONFIGURATIONS**

**Material:** Dual Rated 4710/3608 HDPE Resin, Black  
**Standards:** AWWA C906

**IPS 22½° Bend**

Two-Segment, Fabricated

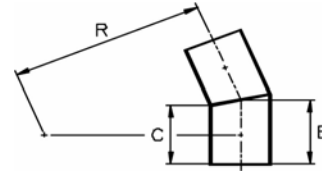

Nominal Size	Body DR	End DR	Part Number	Dimensions R x C x B (in)	Weight per Item (lbs.)	List Price
16	17	17	65-382616	24 x 8 x 9½	31.0	\$ 242.00
	11	17	65-342616		46.0	\$ 315.00
	11	15.5	65-332616		46.0	\$ 315.00
	11	13.5	65-322616		46.0	\$ 315.00
	11	11	65-312616		46.0	\$ 280.00
	9	11	65-292616		55.0	\$ 451.00
	9	9	65-282616		55.0	\$ 329.00
	7	9	65-262616		66.0	\$ 473.00
	7	7	65-252616		66.0	\$ 372.00
18	17	17	65-382618	27 x 8 x 9¾	41.0	\$ 320.00
	11	17	65-342618		60.0	\$ 523.00
	11	15.5	65-332618		60.0	\$ 523.00
	11	13.5	65-322618		60.0	\$ 523.00
	11	11	65-312618		60.0	\$ 386.00
	9	11	65-292618		71.0	\$ 560.00
	9	9	65-282618		71.0	\$ 423.00
	7	9	65-262618		85.0	\$ 619.00
	7	7	65-252618		85.0	\$ 480.00
20	17	17	65-382620	30 x 8 x 10	51.0	\$ 347.00
	11	17	65-342620		75.0	\$ 603.00
	11	15.5	65-332620		75.0	\$ 603.00
	11	13.5	65-322620		75.0	\$ 603.00
	11	11	65-312620		75.0	\$ 435.00
	9	11	65-292620		90.0	\$ 651.00
	9	9	65-282620		90.0	\$ 483.00
	7	9	65-262620		108.0	\$ 772.00
	7	7	65-252620		108.0	\$ 606.00
22	17	17	65-382622	33 x 8 x 10¼	63.0	\$ 426.00
	11	17	65-342622		93.0	\$ 743.00
	11	15.5	65-332622		93.0	\$ 743.00
	11	13.5	65-322622		93.0	\$ 743.00
	11	11	65-312622		93.0	\$ 520.00
	9	11	65-292622		111.0	\$ 1,005.00
	9	9	65-282622		111.0	\$ 796.00
	7	9	65-262622		133.0	\$ 1,014.00
	7	7	65-252622		133.0	\$ 813.00
24	17	17	65-382624	36 x 8 x 10¾	76.0	\$ 475.00
	11	17	65-342624		113.0	\$ 858.00
	11	15.5	65-332624		113.0	\$ 858.00
	11	13.5	65-322624		113.0	\$ 858.00
	11	11	65-312624		113.0	\$ 595.00
	9	11	65-292624		135.0	\$ 932.00
	9	9	65-282624		135.0	\$ 666.00
	7	9	65-262624		161.0	\$ 1,110.00
	7	7	65-252624		161.0	\$ 846.00

IPS Fabricated, Butt Fusion

**DISCOUNT CATEGORY A**

**CALL FOR OTHER CONFIGURATIONS**

**Material:** Dual Rated 4710/3608 HDPE Resin, Black  
**Standards:** AWWA C906

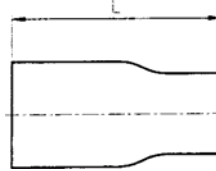

**IPS Swage Reducer**

Fabricated

Nominal Size	DR	Part Number	Dimensions L (in)	Weight per Item (lbs.)	List Price
10 x 8	17	65-38151008	16	11.0	\$ 165.00
	11	65-31151008		16.0	\$ 165.00
	9	65-28151008		19.0	\$ 180.00
12 x 8	17	65-38151208	17	16.0	\$ 240.00
	11	65-31151208		23.0	\$ 258.00
	9	65-28151208		28.0	\$ 294.00
12 x 10	17	65-38151210	16	16.0	\$ 199.00
	11	65-31151210		23.0	\$ 199.00
	9	65-28151210		28.0	\$ 229.00
14 x 10	17	65-38151410	18	20.0	\$ 331.00
	11	65-31151410		30.0	\$ 343.00
	9	65-28151410		35.0	\$ 412.00
14 x 12	17	65-38151412	18	23.0	\$ 235.00
	11	65-31151412		33.0	\$ 247.00
	9	65-28151412		39.0	\$ 283.00
16 x 14	17	65-38151614	18	29.0	\$ 270.00
	11	65-31151614		42.0	\$ 309.00
	9	65-28151614		50.0	\$ 374.00
18 x 14	17	65-38151814	18	33.0	\$ 715.00
	11	65-31151814		49.0	\$ 715.00
	9	65-28151814		59.0	\$ 789.00
18 x 16	17	65-38151816	18	37.0	\$ 369.00
	11	65-31151816		54.0	\$ 403.00
	9	65-28151816		65.0	\$ 479.00
20 x 18	17	65-38152018	20	51.0	\$ 659.00
	11	65-31152018		75.0	\$ 686.00
	9	65-28152018		89.0	\$ 758.00
22 x 20	17	65-38152220	20	62.0	\$ 995.00
	11	65-31152220		92.0	\$ 912.00
	9	65-28152220		109.0	\$ 915.00
24 x 22	17	65-38152422	20	74.0	\$ 1,058.00
	11	65-31152422		110.0	\$ 1,058.00
	9	65-28152422		138.0	\$ 1,163.00

**CALL FOR OTHER CONFIGURATIONS**

# MOLDED IPS BUTT FUSION FITTINGS

**Material:** Dual Rated 4710/3608 HDPE Resin, Black  
**Standards:** ASTM D3261, AWWA C906

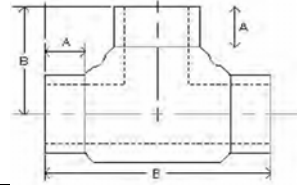

## IPS Tee, Butt Fusion

Molded

Nominal Size	DR	Part Number	Dimensions A x B x L (in)	Weight per Item (lbs.)	List Price
3/4 x 3/4	11	66-3110BB		0.1	\$ 9.75
1 x 1	11	66-3110CC		0.1	\$ 11.04
1 1/4 x 1 1/4	11	66-3110DD		0.3	\$ 11.46
1 1/2 x 1 1/2	11	66-3110EE		0.5	\$ 20.35
2 x 2	11	66-31100202	3.0 x 5.4 x 10.9	1.2	\$ 12.19
3 x 3	11	66-31100303		1.8	\$ 24.87
4 x 4	11	66-31100404	3.0 x 7.3 x 14.8	5.6	\$ 36.17
6 x 6	11	66-31100606		8.7	\$ 89.50
8 x 8	11	66-31100808		20.2	\$ 298.15
10 x 10	11	66-31101010		42.6	\$ 891.43
12 x 12	11	66-31101212		67.0	\$ 1,281.43

**Material:** Dual Rated 4710/3608 HDPE Resin, Black  
**Standards:** ASTM D3261, AWWA C906

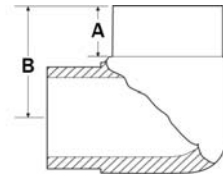

## IPS 90° Bend, Butt Fusion

Molded

Nominal Size	DR	Part Number	Dimensions A x B (in)	Weight per Item (lbs.)	List Price
3/4	11	66-3119B		0.1	\$ 9.38
1	11	66-3119C		0.1	\$ 9.85
1 1/4	11	66-3119D		0.3	\$ 9.25
1 1/2	11	66-3119E		0.5	\$ 8.35
2	11	66-311902		0.8	\$ 9.66
3	11	66-311903	3.0 x 6.3	2.1	\$ 22.23
4	11	66-311904		4.1	\$ 29.92
6	11	66-311906	3.6 x 7.9	8.3	\$ 70.62
8	11	66-311908	6.1 x 12.0	19.6	\$ 238.47
10	11	66-311910		27.1	\$ 849.96
12	11	66-311912		41.1	\$ 849.96

**CALL FOR OTHER CONFIGURATIONS**

**Material:** Dual Rated 4710/3608 HDPE Resin, Black  
**Standards:** ASTM D3261, AWWA C906

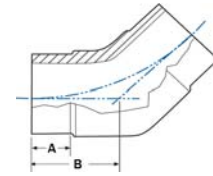

**IPS 45° Bend, Butt Fusion**

Molded

Nominal Size	DR	Part Number	Dimensions A x B (in)	Weight per Item (lbs.)	List Price
3/4	11	66-3122B		0.1	\$ 14.37
1	11	66-3122C		0.1	\$ 14.37
1 1/4	11	66-3122D		0.1	\$ 14.76
1 1/2	11	66-3122E		0.2	\$ 17.96
2	11	66-312202		0.4	\$ 12.55
3	11	66-312203	3.1 x 6.4	1.9	\$ 22.23
4	11	66-312204	3.0 x 6.5	3.5	\$ 29.92
6	11	66-312206		11.0	\$ 70.62
8	11	66-312208	6.0 x 10.8	19.0	\$ 237.16
10	11	66-312210		21.3	\$ 849.96
12	11	66-312212		31.8	\$ 849.96

**Material:** Dual Rated 4710/3608 HDPE Resin, Black  
**Standards:** ASTM D3261, AWWA C906

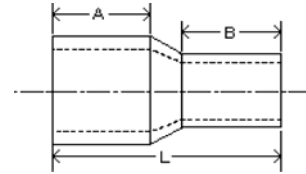

**IPS Reducer, Butt Fusion**

Molded

Nominal Size	DR	Part Number	Dimensions A x B x L (in)	Weight per Item (lbs.)	List Price
1 x 3/4	11	66-3115CB		0.1	\$ 11.98
1 1/4 x 1	11	66-3115DC		0.1	\$ 11.98
1 1/2 x 1	11	66-3115EC		0.3	\$ 15.51
1 1/2 x 1 1/4	11	66-3115ED		0.3	\$ 32.69
2 x 1	11	66-311502C		0.3	\$ 10.16
2 x 1 1/4	11	66-311502D		0.4	\$ 9.33
2 x 1 1/2	11	66-311502E		0.3	\$ 13.27
3 x 2	11	66-31150302		0.7	\$ 14.53
4 x 2	11	66-31150402		1.2	\$ 16.53
4 x 3	11	66-31150403		1.3	\$ 20.78
6 x 3	11	66-31150603		3.2	\$ 82.57
6 x 4	11	66-31150604		3.9	\$ 49.13
8 x 4	11	66-31150804		7.0	\$ 162.96
8 x 6	11	66-31150806		7.2	\$ 96.57
10 x 8	11	66-31151008		3.0	\$ 157.62
12 x 10	11	66-31151210		6.0	\$ 236.36

**CALL FOR OTHER CONFIGURATIONS**

**Material:** Dual Rated 4710/3608 HDPE Resin, Black  
**Standards:** ASTM D3261, AWWA C906

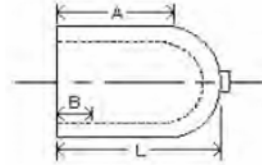

**IPS Cap, Butt Fusion**

Molded

Nominal Size	DR	Part Number	Dimensions A x B x L (in)	Weight per Item (lbs.)	List Price
3/4	11	66-3149B		0.03	\$ 2.97
1	11	66-3149C			\$ 5.66
1 1/4	11	66-3149D		0.1	\$ 6.03
1 1/2	11	66-3149E		0.1	\$ 6.41
2	11	66-314902	2.5 x 1.0 x 3.5	0.2	\$ 6.79
3	11	66-314903		0.5	\$ 8.89
4	11	66-314904	2.4 x 2.6 x 4.5	0.9	\$ 19.20
6	11	66-314906	3.3 x 0.7 x 5.6	2.2	\$ 46.69
8	11	66-314908	5.8 x 4.5 x 9.5	7.2	\$ 83.58
10	11	66-314910		9.0	\$ 261.86
12	11	66-314912		11.0	\$ 270.21

# HDPE IPS TRANSITION FITTINGS AND ADAPTERS

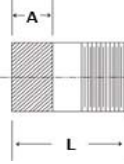
<b>Material:</b> Dual Rated 4710/3608 HDPE Resin, Black; 316 SS					
<b>IPS 316 Stainless Steel Transition Fitting</b>					
MNPT x Butt Fusion					
Nominal Size	DR	Part Number	Dimensions	Weight per Item (lbs.)	List Price
<b>1</b>	11	65-3132C	2.50 x 6.00	0.5	\$ 48.60
	9	65-2832C			\$ 49.20
<b>1¼</b>	11	65-3132D	2.75 x 7.00	0.6	\$ 53.83
	9	65-2832D			\$ 54.67
<b>1½</b>	11	65-3132E	3.50 x 7.50	1.0	\$ 56.07
	9	65-2832E			\$ 61.63
<b>2</b>	11	65-313202	4.00 x 9.00	1.5	\$ 63.57
	9	65-283202			\$ 64.71
<b>3</b>	11	65-313203	5.00 x 9.00	3.0	\$ 111.14
	9	65-283203			\$ 113.18
<b>4</b>	11	65-313204	4.50 x 9.00	4.0	\$ 146.79
	9	65-283204			\$ 149.07

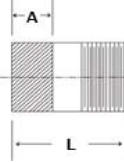
<b>Material:</b> Dual Rated 4710/3608 HDPE Resin, Black; 304 SS					
<b>IPS 304 Stainless Steel Transition Fitting</b>					
MNPT x Butt Fusion					
Nominal Size	DR	Part Number	Dimensions	Weight per Item (lbs.)	List Price
<b>1</b>	11	65-3133C	2.50 x 6.00	0.5	\$ 38.23
	9	65-2833C			\$ 38.83
<b>1¼</b>	11	65-3133D	2.75 x 7.00	0.6	\$ 42.00
	9	65-2833D			\$ 43.29
<b>1½</b>	11	65-3133E	3.50 x 7.50	1.0	\$ 48.22
	9	65-2833E			\$ 49.54
<b>2</b>	11	65-313302	4.00 x 9.00	1.5	\$ 55.23
	9	65-283302			\$ 58.25
<b>3</b>	11	65-313303	5.00 x 9.00	3.0	\$ 98.23
	9	65-283303			\$ 102.77
<b>4</b>	11	65-313304	4.50 x 9.00	4.0	\$ 130.37
	9	65-283304			\$ 137.91

**CALL FOR OTHER CONFIGURATIONS**

**Material:** Dual Rated 4710/3608 HDPE Resin, Black; Red Brass

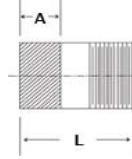

**IPS Brass Transition Fitting**

MNPT x Butt Fusion

Nominal Size	DR	Part Number	Dimensions A x L (in)	Weight per Item (lbs.)	List Price
1	11	65-3135C	2.50 x 6.00	0.5	\$ 44.40
	9	65-2835C			\$ 45.00
1¼	11	65-3135D	2.75 x 7.00	0.6	\$ 52.66
	9	65-2835D			\$ 53.49
1½	11	65-3135E	3.50 x 7.50	1.0	\$ 56.78
	9	65-2835E			\$ 57.31
2	11	65-313502	4.00 x 9.00	1.5	\$ 75.72
	9	65-283502			\$ 76.89
3	11	65-313503	5.00 x 9.00	3.0	\$ 122.43
	9	65-283503			\$ 129.38
4	11	65-313504	4.50 x 9.00	4.0	\$ 178.58
	9	65-283504			\$ 180.84

**Material:** Dual Rated 4710/3608 HDPE Resin, Black; 304 SS

**Standards:** AWWA C906

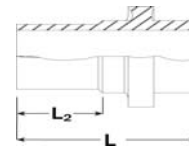

**IPS MJ Adapter with Stiffener**

Nominal Size	DR	Part Number	Dimensions L x L <sub>2</sub>	Weight per Item (lbs.)	List Price
3	11	65-314203	10.25 x 6.50	5.0	\$ 179.14
4	11	65-314204	10.25 x 6.50	6.0	\$ 157.15
6	11	65-314206	11.25 x 7.25	9.0	\$ 211.42
8	11	65-314208	12.75 x 8.75	12.0	\$ 271.42
10	11	65-314210	13.75 x 9.625	20.0	\$ 365.71
12	11	65-314212	14.75 x 10.125	37.0	\$ 405.72
14	11	65-314214	17.50 x 12.50	50.0	\$ 840.00
16	11	65-314216	17.25 x 12.50	67.0	\$ 1,026.86

**IPS MJ Adapter Accessories**

Includes Gland, T-Bolt & Nut, Transition Gasket

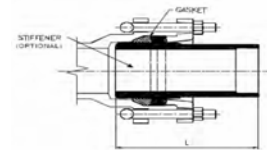

Nominal Size	Part Number	No. of Bolts	Bolt Diameter x Bolt Length	Weight per Item (lbs.)	List Price
3	65-904403	4	.625 x 4.50	8.0	\$ 46.60
4	65-904404	4	.75 x 4.5	9.0	\$ 40.00
6	65-904406	6	.75 x 5	3.0	\$ 56.66
8	65-904408	6	.75 x 7	16.0	\$ 66.20
10	65-904410	8	.75 x 7	21.0	\$ 103.32
12	65-904412	8	.75 x 7	26.0	\$ 110.00
14	65-904414	10	.75 x 7	57.0	\$ 223.32
16	65-904416	12	.75 x 7	71.0	\$ 280.00

**CALL FOR OTHER CONFIGURATIONS**

**Material:** Dual Rated 4710/3608 HDPE Resin, Black  
**Standards:** AWWA C906

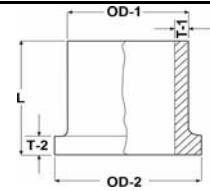

**IPS Flange Adapter**

Nominal Size	DR	Part Number	Thickness T-1 x T-2	Dimensions L x OD-1 x OD-2 (in)	Weight per Item (lbs.)	List Price
2	11	65-316002	0.22 x 0.40	5.98 x 2.37 x 4.00	0.5	\$ 17.58
3	11	65-316003	0.32 x 0.60	5.98 x 3.50 x 5.00	1.0	\$ 21.42
4	11	65-316004	0.41 x 0.80	5.98 x 4.50 x 6.60	2.0	\$ 27.29
6	11	65-316006	0.60 x 0.80	7.99 x 6.63 x 8.50	4.0	\$ 43.12
8	11	65-316008	0.78 x 0.80	9.02 x 8.63 x 10.60	7.0	\$ 60.05
10	11	65-316010	0.98 x 1.30	9.02 x 10.75 x 12.80	11.0	\$ 105.71
12	11	65-316012	1.16 x 1.50	10.79 x 12.75 x 15.00	19.0	\$ 165.72
14	11	65-316014	1.27 x 1.70	11.00 x 14.00 x 17.50	25.0	\$ 262.97
16	11	65-316016	1.45 x 1.90	12.00 x 16.00 x 20.00	35.0	\$ 335.77
18	11	65-316018	1.64 x 2.10	12.00 x 18.00 x 21.10	42.0	\$ 417.49
20	11	65-316020	1.82 x 2.30	12.00 x 20.00 x 23.50	53.0	\$ 671.54
22	11	65-316022	2.00 x 2.50	12.00 x 22.00 x 25.60	65.0	\$ 699.77
24	11	65-316024	2.18 x 2.90	14.00 x 24.00 x 27.90	90.0	\$ 788.91

**Material:** Ductile Iron  
**Standards:** ASTM A536

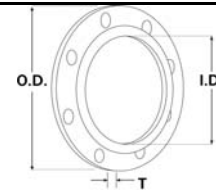

**IPS Ductile Iron Backup Ring**

Nominal Size	DR	Part Number	Dimensions O.D. x I.D. x T (in)	Weight per Item (lbs.)	List Price
2	11	65-077702	6.00 x 2.63 x 0.50	1.5	\$ 8.33
3	11	65-077703	7.50 x 3.75 x 0.53	2.5	\$ 12.85
4	11	65-077704	9.00 x 4.75 x 0.55	3.5	\$ 15.69
6	11	65-077706	11.00 x 6.88 x 0.63	4.5	\$ 20.31
8	11	65-077708	13.50 x 8.88 x 0.85	8.0	\$ 35.36
10	11	65-077710	16.00 x 11.00 x 0.98	12.0	\$ 45.21
12	11	65-077712	19.00 x 13.13 x 1.25	20.0	\$ 80.01
14	11	65-077714	21.00 x 14.38 x 1.38	30.0	\$ 97.86
16	11	65-077716	23.50 x 16.38 x 1.65	40.0	\$ 133.15
18	11	65-077718	25.00 x 18.38 x 1.67	45.0	\$ 147.15
20	11	65-077720	27.50 x 20.38 x 1.81	55.0	\$ 195.15
22	11	65-077722	29.50 x 22.38 x 2.00	65.0	\$ 271.89
24	11	65-077724	32.00 x 24.38 x 2.17	80.0	\$ 284.57

**CALL FOR OTHER CONFIGURATIONS**

**Includes:** Grade 5, Zinc Coated Bolts & Nuts, 1/8" Neoprene Gaskets

**Flange Accessory Kit**  
For HDPE Flange x HDPE Flange

Nominal Size	DR	DR	Part Number	Weight per Item (lbs.)	List Price
2	11	11	65-077002	1.2	\$ 26.03
3	11	11	65-077003	1.4	\$ 26.03
4	11	11	65-077004	3.2	\$ 27.71
6	11	11	65-077006	5.2	\$ 39.66
8	11	11	65-077008	5.6	\$ 41.51
10	11	11	65-077010	13.8	\$ 96.34
12	11	11	65-077012	16.2	\$ 99.57
14	11	11	65-077014	21.6	\$ 143.29
16	11	11	65-077016	30.4	\$ 185.71
18	11	11	65-077018	42.4	\$ 281.29
20	11	11	65-077020	55.0	\$ 285.69
22	11	11	65-077022	81.0	\$ 443.66
24	11	11	65-077024	81.0	\$ 448.69

**Includes:** Grade 5, Zinc Coated Bolts & Nuts, 1/8" Neoprene Gaskets

**Flange Accessory Kit**  
For HDPE Flange x HARCO Flange

Nominal Size	DR	DR	Part Number	Weight per Item (lbs.)	List Price
3	11		65-077103	1.4	\$ 26.03
4	11		65-077104	3.2	\$ 27.71
6	11		65-077106	5.2	\$ 39.66
8	11		65-077108	5.6	\$ 41.51
10	11		65-077110	13.8	\$ 96.34
12	11		65-077112	16.2	\$ 99.57

**Includes:** Grade 5, Zinc Coated Bolts & Nuts, 1/8" Neoprene Gaskets

**Flange Accessory Kit**  
For HDPE Flange x Iron/Steel Flange

Nominal Size	DR	DR	Part Number	Weight per Item (lbs.)	List Price
2	11		65-077202	1.2	\$ 26.03
3	11		65-077203	1.4	\$ 26.03
4	11		65-077204	3.2	\$ 27.71
6	11		65-077206	5.2	\$ 39.66
8	11		65-077208	5.6	\$ 41.51
10	11		65-077210	13.8	\$ 96.34
12	11		65-077212	16.2	\$ 99.57
14	11		65-077214	21.6	\$ 143.29
16	11		65-077216	30.4	\$ 185.71
18	11		65-077218	42.4	\$ 281.29
20	11		65-077220	55.0	\$ 285.69
24	11		65-077224	81.0	\$ 448.69

**CALL FOR OTHER CONFIGURATIONS**

**Material:** 304 SS



## IPS Stiffener

For Use with HARCO Ductile Iron Fittings and Valves

Nominal Size	DR	Part Number	Dimensions Length	Weight per Item (lbs.)	List Price
<b>2</b>	11	65-90481102	4¾	0.2	\$ 19.47
	13.5	65-90481302	4¾	0.2	\$ 19.47
	15.5	65-90481502	4¾	0.2	\$ 19.47
	17	65-90481702	4¾	0.2	\$ 19.47
<b>3</b>	11	65-90481103	4¾	0.3	\$ 32.73
	13.5	65-90481303	4¾	0.3	\$ 32.73
	15.5	65-90481503	4¾	0.3	\$ 32.73
	17	65-90481703	4¾	0.3	\$ 32.73

**CALL FOR OTHER CONFIGURATIONS**

# IPS SOCKET FUSION HDPE FITTINGS

**Material:** Dual Rated 4710/3608 HDPE Resin, Black  
**Standards:** ASTM D2683, AWWA C906

## IPS Tee, Socket Fusion Molded



Nominal Size	DR	Part Number	Dimensions	Weight per Item (lbs.)	List Price
3/4 X 3/4 X 3/4	11	69-3110BB		0.1	\$ 3.30
1 X 1 X 1	11	69-3110CC		0.2	\$ 4.21
1 1/4 X 3/4 X 3/4	11	69-3110DBB		0.5	\$ 10.86
1 1/4 X 3/4 X 1	11	69-3110DBC			\$ 10.86
1 1/4 X 3/4 X 1 1/4	11	69-3110DBD			\$ 10.86
1 1/4 X 1 X 3/4	11	69-3110DCB		0.5	\$ 10.86
1 1/4 X 1 1/4 X 3/4	11	69-3110DB			\$ 10.37
1 1/4 X 1 X 1	11	69-3110DCC		0.5	\$ 10.86
1 1/4 X 1 1/4 X 1	11	69-3110DC		0.4	\$ 10.37
1 1/4 X 1 1/4 X 1 1/4	11	69-3110DD		0.4	\$ 5.89
1 1/4 X 1 X 1 1/4	11	69-3110DCD			\$ 10.86
1 1/2 X 3/4 X 3/4	11	69-3110EBB		0.7	\$ 13.79
1 1/2 X 3/4 X 1	11	69-3110EBC			\$ 13.79
1 1/2 X 3/4 X 1 1/4	11	69-3110EBD			\$ 13.79
1 1/2 X 3/4 X 1 1/2	11	69-3110EBE			\$ 13.79
1 1/2 X 1 X 3/4	11	69-3110ECB			\$ 13.79
1 1/2 X 1 X 1	11	69-3110ECC		0.7	\$ 13.79
1 1/2 X 1 X 1 1/4	11	69-3110ECD			\$ 13.79
1 1/2 X 1 X 1 1/2	11	69-3110ECE		1.6	\$ 13.79
1 1/2 X 1 1/4 X 3/4	11	69-3110EDB			\$ 13.79
1 1/2 X 1 1/4 X 1	11	69-3110EDC			\$ 13.79
1 1/2 X 1 1/4 X 1 1/4	11	69-3110EDD		0.6	\$ 13.79
1 1/2 X 1 1/4 X 1 1/2	11	69-3110EDE			\$ 13.79
1 1/2 X 1 1/2 X 3/4	11	69-3110EB			\$ 13.41
1 1/2 X 1 1/2 X 1	11	69-3110EC		0.6	\$ 13.41
1 1/2 X 1 1/2 X 1 1/4	11	69-3110ED		0.6	\$ 13.41
1 1/2 X 1 1/2 X 1 1/2	11	69-3110EE		1.2	\$ 11.49
2 X 1 1/4 X 3/4	11	69-311002DB		1.3	\$ 15.05
2 X 1 1/4 X 1	11	69-311002DC		1.3	\$ 15.05
2 X 1 1/4 X 1 1/4	11	69-311002DD		1.2	\$ 15.05
2 X 1 1/2 X 3/4	11	69-311002EB		1.3	\$ 15.05
2 X 1 1/2 X 1	11	69-311002EC		1.3	\$ 15.05
2 X 1 1/2 X 1 1/4	11	69-311002ED			\$ 15.05
2 X 2 X 3/4	11	69-31100202B		1.3	\$ 14.65
2 X 2 X 1	11	69-311002C			\$ 14.65
2 X 2 X 1 1/4	11	69-311002D			\$ 14.65
2 X 2 X 2	11	69-31100202	3.1 x 3.0	1.2	\$ 11.89
3 X 3 X 3	11	69-31100303	4.3 x 4.3	3.9	\$ 41.03
4 X 4 X 4	11	69-31100404			\$ 75.58

IPS Molded, Socket Fusion

**DISCOUNT CATEGORY D**

HARRINGTON CORPORATION - PO BOX 10335 - LYNCHBURG, VA 24506-0335  
PHONE 434-845-7094 - FAX 434-845-8562 - E-MAIL: [sales@harcofittings.com](mailto:sales@harcofittings.com) - [www.harcofittings.com](http://www.harcofittings.com)

**CALL FOR OTHER CONFIGURATIONS**

**Material:** Dual Rated 4710/3608 HDPE Resin, Black  
**Standards:** ASTM D2683, AWWA C906



**IPS Reducer, Socket Fusion**

Molded

Nominal Size	DR	Part Number	Dimensions	Weight per Item (lbs.)	List Price
1 x 3/4	11	69-3115CB		0.1	\$ 5.89
1 1/4 x 3/4	11	69-3115DB		0.2	\$ 10.39
1 1/4 x 1	11	69-3115DC		0.2	\$ 9.90
1 1/2 x 3/4	11	69-3115EB		0.2	\$ 12.48
1 1/2 x 1 1/4	11	69-3115ED		0.2	\$ 11.89
2 x 3/4	11	69-311502B		0.4	\$ 11.22
2 x 1	11	69-311502C		0.3	\$ 11.22
2 x 1 1/4	11	69-311502D		0.4	\$ 11.22
2 x 1 1/2	11	69-311502E			\$ 12.41
3 x 2	11	69-31150302			\$ 13.99
4 x 2	11	69-31150402			\$ 26.27
4 x 3	11	69-31150403			\$ 28.72

**Material:** Dual Rated 4710/3608 HDPE Resin, Black  
**Standards:** ASTM D2683, AWWA C906



**IPS 90° Bend, Socket Fusion**

Molded

Nominal Size	DR	Part Number	Dimensions	Weight per Item (lbs.)	List Price
3/4	11	69-3119B		0.1	\$ 3.97
1	11	69-3119C		0.2	\$ 5.28
1 1/4	11	69-3119D		0.3	\$ 5.28
1 1/2	11	69-3119E			\$ 9.11
2	11	69-311902		0.9	\$ 8.91
3	11	69-311903	4.1	3.1	\$ 25.31
4	11	69-311904			\$ 126.32

**Material:** Dual Rated 4710/3608 HDPE Resin, Black  
**Standards:** ASTM D2683, AWWA C906



**IPS 45° Bend, Socket Fusion**

Molded

Nominal Size	DR	Part Number	Dimensions	Weight per Item (lbs.)	List Price
2	11	69-312202	1.7	0.4	\$ 14.86
3	11	69-312203	2.4	1.9	\$ 26.14

**CALL FOR OTHER CONFIGURATIONS**

**Material:** Dual Rated 4710/3608 HDPE Resin, Black  
**Standards:** ASTM D2683, AWWA C906

**IPS Coupling, Socket Fusion**

Molded



Nominal Size	DR	Part Number	Dimensions	Weight per Item (lbs.)	List Price
3/4	11	69-3109B			\$ 1.92
1	11	69-3109C			\$ 1.92
1 1/4	11	69-3109D		0.1	\$ 2.01
1 1/2	11	69-3109E		0.2	\$ 2.78
2	11	69-310902	2.16	0.3	\$ 2.85
3	11	69-310903		0.3	\$ 17.29
4	11	69-310904		1.9	\$ 24.51

**Material:** Dual Rated 4710/3608 HDPE Resin, Black  
**Standards:** ASTM D2683, AWWA C906

**IPS Cap, Socket Fusion**

Molded



Nominal Size	DR	Part Number	Dimensions	Weight per Item (lbs.)	List Price
3/4	11	69-3149B		0.1	\$ 2.97
1	11	69-3149C		0.1	\$ 3.97
1 1/4	11	69-3149D		0.1	\$ 4.35
1 1/2	11	69-3149E			\$ 4.49
2	11	69-314902	0.9 x 1.1 x 2.5	0.4	\$ 4.48
3	11	69-314903		1.0	\$ 26.97
4	11	69-314904		2.2	\$ 48.34

**CALL FOR OTHER CONFIGURATIONS**

# IPS ELECTROFUSION HDPE FITTINGS

**Material:** Dual Rated 4710/3608 HDPE Resin, Black  
**Standards:** ASTM F1055, AWWA C906

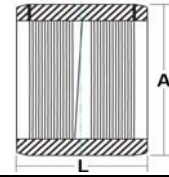

## IPS Coupling, Electrofusion

Molded

Nominal Size	PSI Rating	Part Number	Dimensions L x A	Weight per Item (lbs.)	List Price
3/4	230 psi	70-09B		0.1	\$ 13.73
1	230 psi	70-09C		0.2	\$ 14.36
1 1/4	230 psi	70-09D		0.25	\$ 15.60
1 1/2	230 psi	70-09E		0.4	\$ 18.40
2	230 psi	70-0902		0.6	\$ 18.58
3	230 psi	70-0903		1.2	\$ 42.76
4	230 psi	70-0904		2.0	\$ 57.02
6	230 psi	70-0906		4.2	\$ 136.89
8	230 psi	70-0908		5.0	\$ 189.87
10	230 psi	70-0910		15	\$ 466.67
12	230 psi	70-0912		25	\$ 755.56
14	230 psi	70-0914		37	\$ 1,000.00
16	230 psi	70-0916		41	\$ 1,222.22
18	230 psi	70-0918		63	\$ 2,000.00
20	230 psi	70-0920		72	\$ 2,222.22
24	230 psi	70-0924		100	\$ 3,555.56

**Material:** Dual Rated 4710/3608 HDPE Resin, Black  
**Standards:** ASTM F1055, AWWA C906

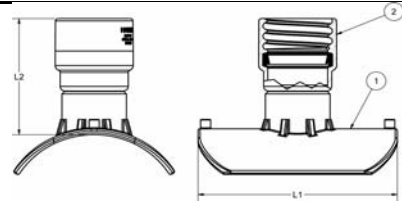

## IPS Electrofusion Swivel Saddle

EF x Swivel; Friatec Based

Nominal Size	PSI Rating	Part Number	Dimensions L1 x L2	Weight per Item (lbs.)	List Price
3	200 psi	70-5103	5.1 x 6.4		\$ 147.06
4	200 psi	70-5104	7.3 x 6.4		\$ 150.06
6	200 psi	70-5106	7.7 x 6.4		\$ 182.44
8	200 psi	70-5108	7.6 x 6.4		\$ 191.38
10 - 24	200 psi	70-5110	7.8 x 6.3		\$ 401.65

**CALL FOR OTHER CONFIGURATIONS**

**Material:** Dual Rated 4710/3608 HDPE Resin, Black  
**Standards:** ASTM F1055, AWWA C906

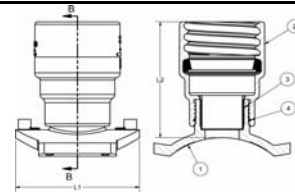

## IPS Electrofusion Swivel Saddle

EF x Swivel; Nupi Based

Nominal Size	PSI Rating	Part Number	Dimensions L1 x L2	Weight per Item (lbs.)	List Price
<b>3</b>	<b>200 psi</b>	70-5303	5.6 x 6.1	5	\$ 127.83
<b>4</b>	<b>200 psi</b>	70-5304	5.6 x 6.1	5	\$ 143.89
<b>6</b>	<b>200 psi</b>	70-5306	5.6 x 6.1	5	\$ 163.89
<b>8</b>	<b>200 psi</b>	70-5308	5.6 x 6.1	5	\$ 186.00
<b>10</b>	<b>200 psi</b>	70-5310	5.6 x 6.1	5	\$ 199.94
<b>12</b>	<b>200 psi</b>	70-5312	5.6 x 6.1	5	\$ 216.00
<b>14 - 24</b>	<b>200 psi</b>	70-5314	5.6 x 6.1	5	\$ 333.71

**Material:** Dual Rated 4710/3608 HDPE Resin, Black  
**Standards:** ASTM F1055, AWWA C906

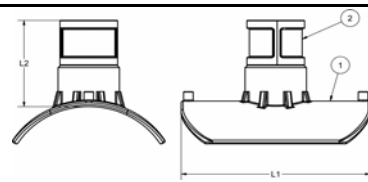

## IPS Electrofusion Service Saddle

EF x FNPT, Friatec Based

Nominal Size	PSI Rating	Part Number	Dimensions L1 x L2	Weight per Item (lbs.)	List Price
<b>3 x 1</b>	<b>200 psi</b>	70-550304	5.9 x 5.2		\$ 164.71
<b>3 x 1½</b>	<b>200 psi</b>	70-550306	5.9 x 5.2		\$ 161.76
<b>3 x 2</b>	<b>200 psi</b>	70-550308	5.9 x 5.2		\$ 155.88
<b>4 x 1</b>	<b>200 psi</b>	70-550404	7.3 x 5.2		\$ 167.65
<b>4 x 1½</b>	<b>200 psi</b>	70-550406	7.3 x 5.2		\$ 164.71
<b>4 x 2</b>	<b>200 psi</b>	70-550408	7.3 x 5.2		\$ 158.88
<b>6 x 1</b>	<b>200 psi</b>	70-550604	7.7 x 5.2		\$ 200.09
<b>6 x 1½</b>	<b>200 psi</b>	70-550606	7.7 x 5.2		\$ 197.15
<b>6 x 2</b>	<b>200 psi</b>	70-550608	7.7 x 5.2		\$ 191.26
<b>8 x 1</b>	<b>200 psi</b>	70-550804	7.6 x 5.2		\$ 209.03
<b>8 x 1½</b>	<b>200 psi</b>	70-550806	7.6 x 5.2		\$ 206.09
<b>8 x 2</b>	<b>200 psi</b>	70-550808	7.6 x 5.2		\$ 200.21
<b>10 - 24 x 1</b>	<b>200 psi</b>	70-551004	7.8 x 5.1		\$ 419.29
<b>10 - 24 x 1½</b>	<b>200 psi</b>	70-551006	7.8 x 5.1		\$ 416.35
<b>10 - 24 x 2</b>	<b>200 psi</b>	70-551008	7.8 x 5.1		\$ 410.47

**CALL FOR OTHER CONFIGURATIONS**

**Material:** Dual Rated 4710/3608 HDPE Resin, Black  
**Standards:** ASTM F1055, AWWA C906

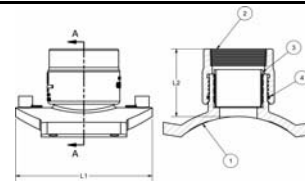

## IPS Electrofusion Service Saddle

EF x FNPT, Nupi Based

Nominal Size	PSI Rating	Part Number	Dimensions L1 x L2	Weight per Item (lbs.)	List Price
3 x 1	200 psi	70-540304	5.6 x 3.0	4	\$ 144.97
3 x 1½	200 psi	70-540306	5.6 x 3.0	4	\$ 139.26
3 x 2	200 psi	70-540308	5.6 x 3.0	4	\$ 127.83
4 x 1	200 psi	70-540404	5.6 x 3.0	4	\$ 161.03
4 x 1½	200 psi	70-540406	5.6 x 3.0	4	\$ 155.31
4 x 2	200 psi	70-540408	5.6 x 3.0	4	\$ 143.89
6 x 1	200 psi	70-540604	5.6 x 3.0	4	\$ 181.03
6 x 1½	200 psi	70-540606	5.6 x 3.0	4	\$ 175.31
6 x 2	200 psi	70-540608	5.6 x 3.0	4	\$ 163.89
8 x 1	200 psi	70-540804	5.6 x 3.0	4	\$ 203.14
8 x 1½	200 psi	70-540806	5.6 x 3.0	4	\$ 197.43
8 x 2	200 psi	70-540808	5.6 x 3.0	4	\$ 186.00
10 x 1	200 psi	70-541004	5.6 x 3.0	4	\$ 217.09
10 x 1½	200 psi	70-541006	5.6 x 3.0	4	\$ 211.37
10 x 2	200 psi	70-541008	5.6 x 3.0	4	\$ 199.94
12 x 1	200 psi	70-541204	5.6 x 3.0	4	\$ 233.14
12 x 1½	200 psi	70-541206	5.6 x 3.0	4	\$ 227.43
12 x 2	200 psi	70-541208	5.6 x 3.0	4	\$ 216.00
14 - 24 x 1	200 psi	70-541404	5.6 x 3.0	4	\$ 350.86
14 - 24 x 1½	200 psi	70-541406	5.6 x 3.0	4	\$ 345.14
14 - 24 x 2	200 psi	70-541408	5.6 x 3.0	4	\$ 333.71

**Material:** Dual Rated 4710/3608 HDPE Resin, Black  
**Standards:** ASTM F1055, AWWA C906

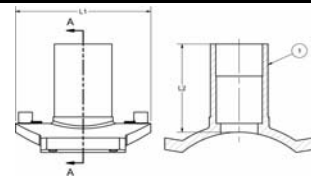

## IPS Electrofusion Branch Saddle

EF x BF, Nupi Based

Nominal Size	PSI Rating	Part Number	Dimensions A x B	Weight per Item (lbs.)	List Price
3 x 2	200 psi	70-560302	5.6 x 4.0	1.2	\$ 64.11
4 x 2	200 psi	70-560402	5.6 x 4.0	1.2	\$ 80.17
4 x 3	200 psi	70-560403	6.7 x 5.0	2.2	\$ 120.23
6 x 2	200 psi	70-560602	5.6 x 4.0	2.2	\$ 100.17
6 x 3	200 psi	70-560603	6.7 x 5.0	1.2	\$ 137.26
6 x 4	200 psi	70-560604	7.9 x 5.1	3.3	\$ 224.40
8 x 2	200 psi	70-560802	5.6 x 4.0	1.2	\$ 122.29
8 x 3	200 psi	70-560803	7.9 x 5.0	2.2	\$ 150.80
8 x 4	200 psi	70-560804	7.9 x 5.0	3.3	\$ 240.43
10 x 2	200 psi	70-561002	5.6 x 4.0	1.3	\$ 136.23
10 x 3	200 psi	70-561003	7.9 x 5.0	3.5	\$ 172.31
10 x 4	200 psi	70-561004	7.9 x 5.0	3.7	\$ 276.49
12 x 2	200 psi	70-561202	5.6 x 4.0	1.3	\$ 152.29
12 x 3	200 psi	70-561203	7.9 x 5.0	3.5	\$ 194.37
12 x 4	200 psi	70-561204	7.9 x 5.0	3.7	\$ 312.57
12 x 6	200 psi	70-561206		6.1	\$ 600.00
14 - 24 x 2	200 psi	70-561402	5.6 x 4.0	1.3	\$ 270.00