

# PRICE LIST

## HARCO HEAVY WALL SDR 26

### PVC GASKETED SEWER FITTINGS

FREIGHT — F.O.B. Lynchburg, Virginia

*ALL FITTINGS MEET OR EXCEED:*

|                |                     |
|----------------|---------------------|
| FITTINGS       | ASTM D-3034, F-1336 |
| MATERIALS      | ASTM D-1784         |
| JOINTS         | ASTM D-3212         |
| GASKETS        | ASTM F-477          |
| WALL THICKNESS | SDR-26              |
| INSTALLATION   | ASTM D-2321         |

|  |              | <b>45° WYE<br/>(GxGxG)</b> |           |          |
|---|--------------|----------------------------|-----------|----------|
| SIZE  | PART NUMBER  | LIST PRICE                 | CTN. QTY. | CTN. WT. |
| 4 x 4*  | 501-0404     | \$ 33.79                   | 12        | 29       |
| 6 x 4*  | 501-0604     | 43.88                      | 6         | 29       |
| 6 x 6*  | 501-0606     | 54.90                      | 4         | 27       |
| 8 x 4*  | 501-0804     | 62.07                      | 4         | 42       |
| + 8 x 4-DWV*  | 501-0804-DWV | 62.07                      | 4         | 42       |
| 8 x 6*  | 501-0806     | 71.25                      | 4         | 46       |
| 8 x 8   | 501-0808     | 124.82                     | 1         | 26       |
| 10 x 4*   | 501-1004     | 157.08                     | 2         | 15       |
| 10 x 6*   | 501-1006     | 159.61                     | 2         | 19       |
| 10 x 8  | 501-1008     | 246.62                     | 1         | 23       |
| 10 x 10   | 501-1010     | 298.00                     | 1         | 29       |
| 12 x 4*   | 501-1204     | 214.61                     | 1         | 21       |
| 12 x 6*   | 501-1206     | 217.40                     | 1         | 25       |
| 12 x 8  | 501-1208     | 323.23                     | 1         | 31       |
| 12 x 10   | 501-1210     | 397.03                     | 1         | 37       |
| 12 x 12   | 501-1212     | 422.18                     | 1         | 45       |
| 15 x 4  | 501-1504     | 306.49                     | 1         | 35       |
| 15 x 6  | 501-1506     | 367.12                     | 1         | 40       |
| 15 x 8  | 501-1508     | 409.39                     | 1         | 47       |
| 15 x 10   | 501-1510     | 492.03                     | 1         | 55       |
| 15 x 12   | 501-1512     | 548.13                     | 1         | 65       |
| 15 x 15   | 501-1515     | \$692.10                   | 1         | 86       |

|  |             | <b>TEE-WYE<br/>(GxGxG)</b> |           |          |
|--|-------------|----------------------------|-----------|----------|
| SIZE   | PART NUMBER | LIST PRICE                 | CTN. QTY. | CTN. WT. |
| 4 x 4  | 505-0404    | \$ 40.92                   | 1         | 4        |
| 6 x 4  | 505-0604    | 48.12                      | 1         | 6        |
| 6 x 6  | 505-0606    | 63.07                      | 1         | 10       |
| 8 x 4*   | 505-0804    | 60.76                      | 3         | 32       |
| 8 x 6*   | 505-0806    | 69.47                      | 3         | 32       |
| 8 x 8  | 505-0808    | 156.34                     | 1         | 13       |
| 10 x 4*  | 505-1004    | 179.54                     | 1         | 16       |
| 10 x 6*  | 505-1006    | 201.66                     | 1         | 20       |
| 10 x 8   | 505-1008    | 312.41                     | 1         | 28       |
| 12 x 4*  | 505-1204    | 223.84                     | 1         | 22       |
| 12 x 6*  | 505-1206    | 243.76                     | 1         | 27       |
| 12 x 8   | 505-1208    | 495.14                     | 1         | 39       |
| 15 x 4   | 505-1504    | 352.70                     | 1         | 36       |
| 15 x 6   | 505-1506    | 383.62                     | 1         | 42       |
| 15 x 8   | 505-1508    | \$411.35                   | 1         | 54       |

\*Indicates one-piece molded fitting in color grey. See note on Page 4.

+DWV Solvent Weld Outlet.

**Fittings in Crates:** Some fittings are available in crate quantities at no extra charge. Please contact our Customer Service Department for more information.

NOTE: Please call, fax or e-mail for price and delivery of unlisted sewer fittings.

## HARCO HEAVY WALL SDR 26 PVC GASKETED SEWER FITTINGS PRICE LIST

|  <b>90° BEND<br/>(GxG)</b> |             |            |           |          |
|---|-------------|------------|-----------|----------|
| SIZE  | PART NUMBER | LIST PRICE | CTN. QTY. | CTN. WT. |
| 4   | 518-040     | \$ 26.52   | 1         | 3        |
| 6*  | 518-060     | 57.05      | 12        | 50       |
| 8*  | 518-080     | 132.20     | 4         | 39       |
| 10  | 518-100     | 210.37     | 1         | 19       |
| 12  | 518-120     | 277.94     | 1         | 38       |
| 15  | 518-150     | \$513.34   | 1         | 68       |

|  <b>90° BEND<br/>(GxS)</b> |             |            |           |          |
|---|-------------|------------|-----------|----------|
| SIZE  | PART NUMBER | LIST PRICE | CTN. QTY. | CTN. WT. |
| 4   | 519-040     | \$ 26.52   | 1         | 5        |
| 6*  | 519-060     | 72.79      | 12        | 40       |
| 8*  | 519-080     | 148.79     | 4         | 35       |
| 10  | 519-100     | 210.37     | 1         | 17       |
| 12  | 519-120     | 277.94     | 1         | 19       |
| 15  | 519-150     | \$513.34   | 1         | 65       |

|  <b>45° BEND<br/>(GxG)</b> |             |            |           |          |
|---|-------------|------------|-----------|----------|
| SIZE  | PART NUMBER | LIST PRICE | CTN. QTY. | CTN. WT. |
| 4*  | 522-040     | \$ 14.93   | 24        | 34       |
| 6*  | 522-060     | 27.40      | 12        | 41       |
| 8*  | 522-080     | 66.04      | 4         | 34       |
| 10  | 522-100     | 134.18     | 1         | 18       |
| 12  | 522-120     | 208.42     | 1         | 26       |
| 15  | 522-150     | \$418.38   | 1         | 38       |

|  <b>45° BEND<br/>(GxS)</b> |             |            |           |          |
|---|-------------|------------|-----------|----------|
| SIZE  | PART NUMBER | LIST PRICE | CTN. QTY. | CTN. WT. |
| 4*  | 523-040     | \$ 13.78   | 24        | 24       |
| 6*  | 523-060     | 20.24      | 12        | 34       |
| 8*  | 523-080     | 66.18      | 4         | 28       |
| 10  | 523-100     | 134.18     | 1         | 16       |
| 12  | 523-120     | 208.42     | 1         | 24       |
| 15  | 523-150     | \$418.38   | 1         | 36       |

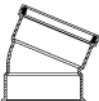
|  <b>22½° BEND<br/>(GxG)</b> |             |            |           |          |
|--|-------------|------------|-----------|----------|
| SIZE   | PART NUMBER | LIST PRICE | CTN. QTY. | CTN. WT. |
| 4*   | 524-040     | \$19.81    | 24        | 34       |
| 6*   | 524-060     | 37.35      | 12        | 38       |
| 8  | 524-080     | 66.39      | 1         | 23       |
| 10   | 524-100     | 147.13     | 1         | 17       |
| 12   | 524-120     | 197.75     | 1         | 24       |
| 15   | 524-150     | \$472.25   | 1         | 42       |

|  <b>22½° BEND<br/>(GxS)</b> |             |            |           |          |
|--|-------------|------------|-----------|----------|
| SIZE   | PART NUMBER | LIST PRICE | CTN. QTY. | CTN. WT. |
| 4*   | 525-040     | \$ 18.96   | 24        | 24       |
| 6*   | 525-060     | 35.77      | 12        | 25       |
| 8  | 525-080     | 66.38      | 4         | 20       |
| 10   | 525-100     | 147.13     | 1         | 16       |
| 12   | 525-120     | 197.75     | 1         | 22       |
| 15   | 525-150     | \$472.25   | 1         | 40       |

\*Indicates one-piece molded fitting in color grey. See note on Page 4.

**Fittings in Crates:** Some fittings are available in crate quantities at no extra charge. Please contact our Customer Service Department for more information.

## HARCO HEAVY WALL SDR 26 PVC GASKETED SEWER FITTINGS PRICE LIST



### TEE (GxGxG)

| SIZE         | PART NUMBER  | LIST PRICE | CTN. QTY. | CTN. WT. |
|--------------|--------------|------------|-----------|----------|
| 4 x 4        | 512-0404     | \$ 35.27   | 1         | 4        |
| 6 x 4        | 512-0604     | 43.66      | 1         | 7        |
| 6 x 6        | 512-0606     | 48.27      | 1         | 7        |
| 8 x 4*       | 512-0804     | 60.76      | 1         | 11       |
| + 8 x 4-DWV* | 512-0804-DWV | 60.76      | 1         | 11       |
| 8 x 6*       | 512-0806     | 67.78      | 3         | 36       |
| 8 x 8        | 512-0808     | 100.31     | 1         | 41       |
| 10 x 4       | 512-1004     | 152.19     | 1         | 15       |
| 10 x 6       | 512-1006     | 155.12     | 1         | 17       |
| 10 x 8       | 512-1008     | 235.67     | 1         | 20       |
| 10 x 10      | 512-1010     | 256.88     | 1         | 24       |
| 12 x 4       | 512-1204     | 194.20     | 1         | 20       |
| 12 x 6       | 512-1206     | 203.39     | 1         | 23       |
| 12 x 8       | 512-1208     | 276.10     | 1         | 28       |
| 12 x 10      | 512-1210     | 329.75     | 1         | 32       |
| 12 x 12      | 512-1212     | 355.95     | 1         | 36       |
| 15 x 4       | 512-1504     | 288.48     | 1         | 34       |
| 15 x 6       | 512-1506     | 317.92     | 1         | 37       |
| 15 x 8       | 512-1508     | 334.77     | 1         | 42       |
| 15 x 10      | 512-1510     | 381.62     | 1         | 48       |
| 15 x 12      | 512-1512     | 449.56     | 1         | 54       |
| 15 x 15      | 512-1515     | \$584.08   | 1         | 65       |

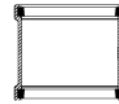

### REPAIR COUPLING No Stop (GxG)

| SIZE | PART NUMBER | LIST PRICE | CTN. QTY. | CTN. WT. |
|------|-------------|------------|-----------|----------|
| 4*   | 509-040     | \$ 14.32   | 36        | 47       |
| 6*   | 509-060     | 32.94      | 18        | 36       |
| 8*   | 509-080     | 54.10      | 12        | 53       |
| 10   | 509-100     | 82.78      | 1         | 12       |
| 12   | 509-120     | 120.19     | 1         | 18       |
| 15   | 509-150     | \$248.65   | 1         | 31       |

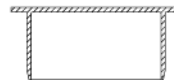

### PERMANENT PLUG (PE)

| SIZE | PART NUMBER | LIST PRICE | CTN. QTY. | CTN. WT. |
|------|-------------|------------|-----------|----------|
| 4*   | 544-040     | \$ 12.07   | 24        | 15       |
| 6*   | 544-060     | 24.34      | 24        | 40       |
| 8*   | 544-080     | 42.99      | 12        | 39       |
| 10   | 544-100     | 82.63      | 1         | 10       |
| 12   | 544-120     | 98.52      | 1         | 16       |
| 15   | 544-150     | \$181.22   | 1         | 23       |

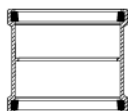

### COUPLING With Stop (GxG)

| SIZE | PART NUMBER | LIST PRICE | CTN. QTY. | CTN. WT. |
|------|-------------|------------|-----------|----------|
| 4*   | 508-040     | \$ 16.45   | 36        | 49       |
| 6*   | 508-060     | 46.49      | 18        | 36       |
| 8*   | 508-080     | 55.69      | 12        | 59       |
| 10   | 508-100     | 82.78      | 1         | 13       |
| 12   | 508-120     | 120.19     | 1         | 20       |
| 15   | 508-150     | \$248.65   | 1         | 33       |



### CAP (G)

| SIZE | PART NUMBER | LIST PRICE | CTN. QTY. | CTN. WT. |
|------|-------------|------------|-----------|----------|
| 4*   | 549-040     | \$ 13.35   | 24        | 21       |
| 6*   | 549-060     | 31.20      | 24        | 46       |
| 8    | 549-080     | 46.20      | 1         | 7        |
| 10   | 549-100     | 89.15      | 1         | 18       |
| 12   | 549-120     | 140.24     | 1         | 18       |
| 15   | 549-150     | \$233.31   | 1         | 26       |

\*Indicates one-piece molded fitting in color grey. See note on Page 4.

+DWV Solvent Weld Outlet.

**Fittings in Crates:** Some fittings are available in crate quantities at no extra charge. Please contact our Customer Service Department for more information.

## HARCO HEAVY WALL SDR 26 PVC GASKETED SEWER FITTINGS PRICE LIST

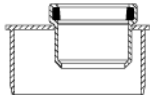

### ECCENTRIC INCREASER (GxS)

| SIZE  | PART NUMBER | LIST PRICE | CTN. QTY. | CTN. WT. |
|-------|-------------|------------|-----------|----------|
| 4 x 6 | 515-0406    | \$ 33.53   | 1         | 19       |
| 4 x 8 | 515-0408    | 71.34      | 1         | 27       |
| 6 x 8 | 515-0608    | \$121.81   | 1         | 21       |

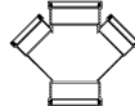

### DOUBLE WYE (GxGxGxG)

| SIZE   | PART NUMBER | LIST PRICE | CTN. QTY. | CTN. WT. |
|--------|-------------|------------|-----------|----------|
| 6 x 4* | 504-0604    | \$ 73.14   | 4         | 21       |
| 6 x 6* | 504-0606    | 97.40      | 2         | 24       |
| 8 x 4  | 504-0804    | 105.35     | 1         | 12.5     |
| 8 x 6  | 504-0806    | \$126.07   | 1         | 12       |



### CONCENTRIC INCREASER (GxS)

| SIZE    | PART NUMBER | LIST PRICE | CTN. QTY. | CTN. WT. |
|---------|-------------|------------|-----------|----------|
| 4 x 6*  | 516-0406    | \$ 28.29   | 12        | 25       |
| 4 x 8   | 516-0408    | 54.12      | 1         | 8        |
| 4 x 10  | 516-0410    | 113.25     | 1         | 9        |
| 4 x 12  | 516-0412    | 171.46     | 1         | 12       |
| 4 x 15  | 516-0415    | 287.96     | 1         | 19       |
| 6 x 8   | 516-0608    | 56.77      | 1         | 9        |
| 6 x 10  | 516-0610    | 134.23     | 1         | 11       |
| 6 x 12  | 516-0612    | 180.22     | 1         | 13       |
| 6 x 15  | 516-0615    | 292.21     | 1         | 19       |
| 8 x 10  | 516-0810    | 155.65     | 1         | 12       |
| 8 x 12  | 516-0812    | 207.63     | 1         | 12       |
| 8 x 15  | 516-0815    | 316.84     | 1         | 21       |
| 10 x 12 | 516-1012    | 240.62     | 1         | 16       |
| 10 x 15 | 516-1015    | 349.18     | 1         | 21       |
| 12 x 15 | 516-1215    | \$379.72   | 1         | 27       |

\*Indicates one-piece molded fitting in color grey. See note below.

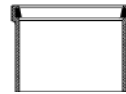

### MANHOLE ADAPTER Single Bell (G) Sand Coating on Exterior

| SIZE | PART NUMBER | LIST PRICE | CTN. QTY. | CTN. WT. |
|------|-------------|------------|-----------|----------|
| 4*   | 558-040     | \$ 17.37   | 1         | 1        |
| 6*   | 558-060     | 32.78      | 1         | 3        |
| 8*   | 558-080     | 36.37      | 1         | 4        |
| 10   | 558-100     | 66.38      | 1         | 6        |
| 12   | 558-120     | 97.28      | 1         | 9        |
| 15   | 558-150     | \$124.63   | 1         | 16       |

**Fittings in Crates:** Some fittings are available in crate quantities at no extra charge. Please contact our Customer Service Department for more information.

SDR 26 Heavy Wall, One-Piece Molded Sewer Fittings are now identifiable by the color grey. We are currently shipping the remainder of previously molded white inventory. Shipments may temporarily consist of both the grey and white color scheme. The material compound has not changed and all SDR 26 Heavy Wall Sewer Fittings continue to conform to ASTM-3034 and ASTM F-1336 standards.