

# HARCO DUCTILE IRON PUSH ON WYES

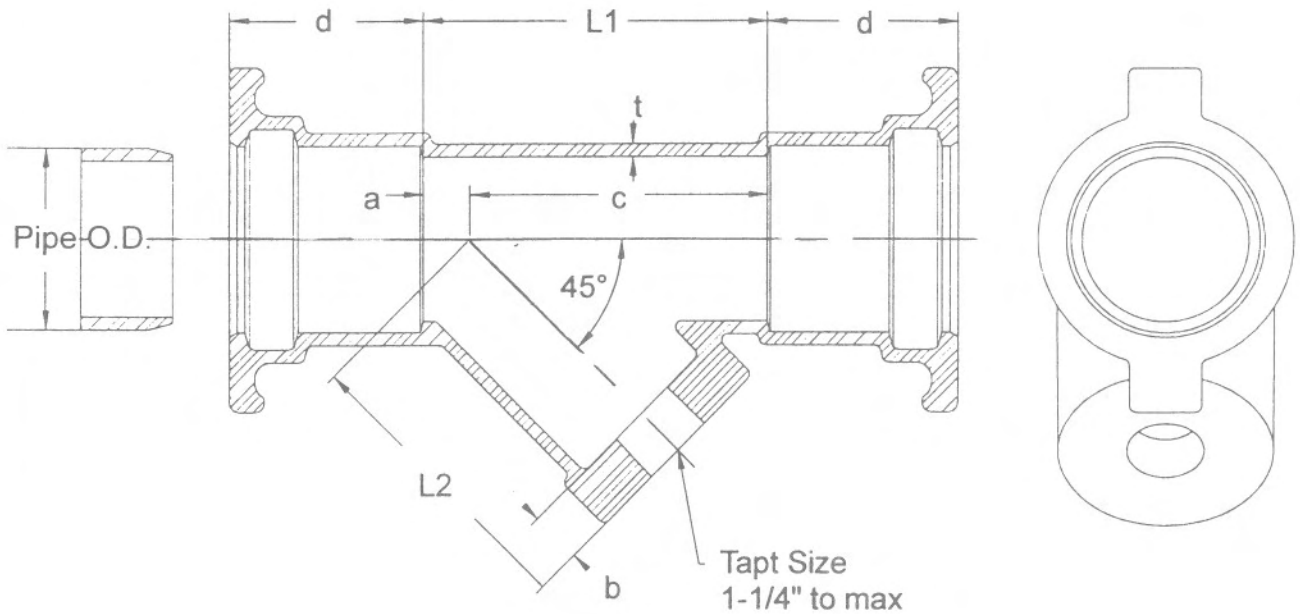

Part No.	Size	a	b	c	d	L1	L2	t	Max Tapt	Pipe O.D.
80010	1-1/2"	0.61	0.75	3.00	3.28	3.61	3.74	0.25	1-1/2	1.900
80110	2"	0.70	0.75	3.06	3.48	3.76	4.06	0.25	2	2.375
80210	2-1/2"	0.79	1.00	4.42	3.48	5.21	4.63	0.25	2-1/2	2.875
80310	3"	0.91	1.00	5.79	3.75	6.70	5.73	0.25	3	3.500

Note: All dimensions in inches.

**Material Specifications:**

Fittings - Ductile Iron, meets or exceeds ASTM A536

Gaskets - SBR (Styrene Butadiene Rubber), meets or exceeds ASTM F477

Tapt Outlet - NPT Threads meeting ANSI/ASME B1.20.1-1983

2-23-96

THE HARRINGTON CORPORATION  
PHONE 434-845-7094

P.O BOX 10335

LYNCHBURG, VA 24506  
FAX 434-845-8562