

## FITTINGS

### TAPPED SERVICE TEE FOR C-900 PVC PIPE

#### HARCO Molded, One-Piece PVC Service Tee



Tapped tees designed for C-900 PVC pipe are available from HARCO Fittings in 4", 6" and 8" sizes with AWWA or IPT threads ( $\frac{3}{4}$ " through 2"). These fittings are manufactured to the same design and standards as the tough HARCO PVC-907 fittings. *These fittings eliminate the problems of direct tapping of C-907 PVC pipe and the uncertainty of incorrectly installed saddles.* With the same corrosion resistance of PVC pipe, HARCO tapped service tees allow for a totally corrosion proof service connection.

HARCO Fittings service tee threads are molded in a reinforced boss...the one-inch thickness assures that the corporation stop will not pull out. These threads have withstood 5,000-pound pull-out tests and will withstand 75 foot-pounds of torque without damage, thereby *preventing overtorquing problems.* By eliminating the direct tap, *the potential weak spot introduced by putting a hole in the pipe is eliminated, the pipe wall integrity is preserved and the safety hazard associated with tapping is removed.*

#### Tapped Tees vs. Saddle in Main

- Dull bits and drilling procedures can cause stress on pipe, creating potential future pipe failure.
- Saddle can be mispositioned. Bolts can be too tight or too loose.
- Metallic saddle will corrode. Iron to brass results in dissimilar metal corrosion.
- Drilling shavings can enter pipe; failure to recover coupon or shavings will contaminate pipe and create blockage.
- Drilled hole in pipe wall destroys structural integrity. Saddle will not replace missing material. Creates combined stresses beyond hole.

- Pipe temperature is critical on drilling holes in pipe. Too hot or too cold will crack pipe.
- No assurance to owner that all contractor personnel are properly trained in drilling holes and installing saddles.

#### Tapped Tees vs. Press Hot Taps

- Safety: potential always exists for accident if all procedures are not followed or if pipe is defective.
- Tapped Tees eliminate a tap at an over-stressed point in the pipe because of two gasketed joints within 13".
- Two gasketed joints provide extra isolation and degree of freedom between service and main.

C-900

• **1" Thick Molded Boss Reinforces Wall and Provides Superior Strength**

• **Eliminates Overtorque of Saddle Bolts**

• **No Corrosion**

• **Easy and Quick Installation**



HARRINGTON CORPORATION • P.O. BOX 10335 • LYNCHBURG, VIRGINIA 24506

PHONE: 434-845-7094 • FAX: 434-845-8562 • E-MAIL: sales@harcofittings.com • WEB: www.harcofittings.com

PF102-12102002

# TAPPED SERVICE TEE FOR C-900 PIPE

## Product Sheet

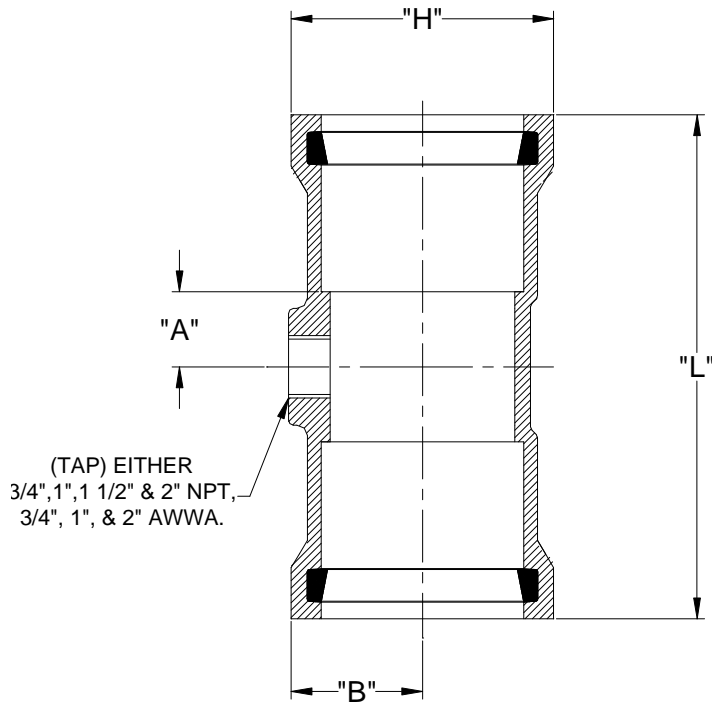

SIZE	PROD. NO.	A	B	H	L	T	WT	THREADS
4	351- 40X	3.6	3.2	6.9	12.0	0.32	5.0	NPT
	352- 40X							AWWA
6	351- 60X	3.9	4.1	8.5	13.0	0.45	9.2	NPT
	352- 60X							AWWA
8	351- 80X	4.1	5.2	11.0	14.9	0.58	16.0	NPT
	352- 80X							AWWA

Note: For tap sizes,  
replace "X" in the  
product number as  
follows:

**3 = 3/4"**  
**4 = 1"**  
**6 = 1 1/2"**  
**8 = 2"**

**For Example: 351-403 = 4" x 3/4" Fitting**

### Suggested Specifications

Tapped Service Tees shall be manufactured in one piece of injection molded PVC compound meeting ASTM 1784, with outlet threads molded in place. Fittings shall be Class 150 psi and conform to wall thickness DR 18. Bells shall be gasketed type joint conforming to ASTM D3139 with gaskets conforming to ASTM F477. Fittings shall withstand 755 psi quick burst test in accordance with ASTM 1599. Fittings shall be as manufactured by HARCO, Lynchburg, Virginia or an approved equal.

### Installation Instructions

Inspect fittings and assure that interior is clean and free of dirt. Cut and bevel pipe to a 15° angle, 3/4" long. Lubricate fitting gaskets and pipe ends; insert pipe into fitting. The corporation stop can be installed before or after installation of the fitting in the mainline. The corporation stop's tapered thread should be spirally wound with two to three layers of tetrafluoroethylene (Teflon™) pipe thread. No other sealant is recommended. Tighten the inserted corporation stop to a torque of approximately 30 foot-pounds. Install service line and curb stop, and record location for future connection.

### Pullout Resistance Comparison

SIZE	LOAD AT FAILURE	TYPICAL COPPER FLARE CONNECTION FAILURE	REMARKS
4" PVC Pipe Tee 3/4" NPT Thread	5,320 lbs.	3,175 lbs.	Threads Stripped in PVC Pipe Tee
4" PVC Pipe Tee 1" NPT Thread	9,160 lbs.	3,500 lbs.	Threads Stripped in PVC Pipe Tee
6" PVC Pipe Tee 3/4" NPT Thread	9,090 lbs.	3,175 lbs.	Threads Stripped in PVC Pipe Tee
6" PVC Pipe Tee 1" NPT Thread	9,090 lbs.	3,500 lbs.	Threads Stripped in PVC Pipe Tee



HARRINGTON CORPORATION • P.O. BOX 10335 • LYNCHBURG, VIRGINIA 24506

PHONE: 434-845-7094 • FAX: 434-845-8562 • E-MAIL: sales@harcofittings.com • WEB: www.harcofittings.com

PF102-12102002